

STANLEY PAC[®]

READERS | Stanley GS3-LF Mullion Proximity Reader

The GS3-LF Mullion proximity reader offers unsurpassed quality and reliability, together with guaranteed quick and dependable read times keep traffic moving through secure areas.

The attractive enclosure is ideally suited to locations that require a reader with a small footprint that can mount on either a door frame (mullion) or any flat surface. When the reader senses the presentation of a valid card or key fob, a high visibility bi-color LED can be combined with the built-in audible sounder indicating that access has been granted, and tamper notification.

Both reliable and difficult to compromise, the reader is constructed of rugged polycarbonate plastic and potted using flame-retardant resin allowing complete freedom of use - both indoors and out.

The GS3-LF Mullion features simultaneous compatibility with multi-vendor credential technologies, in addition to reading 125KHz KeyPAC/153KHz PAC/Readykey™ credentials and most HID® 125 kHz Proximity, HID Corporate 1000® Proximity, — all in one reader!

Key Features

- Up to 4 inch reading range
- Easy installation with low cost 22AWG Unshielded 4-conductor cable when connected to the Stanley PAC512 Door Controllers or 22-5 Shielded for Wiegand controllers
- Reads KeyPAC and PAC/Readykey™ and most HID® 125 kHz Proximity and HID® Corporate 1000® Proximity credentials
- Fast and dependable read times
- Flexible, operates with most access controllers and burg panels that utilize a Wiegand protocol interface
- ADA compliant audiovisual indication making secure areas equally accessible to disabled users
- Wall tamper compliant to UL 294 and ULC S319 offering a true Class 3 reader option for access systems
- Suitable for indoor and outdoor use. Sealed in a rugged weatherized polycarbonate enclosure to withstand harsh environments
- Lifetime Warranty



FEATURES AND SPECIFICATIONS CHART



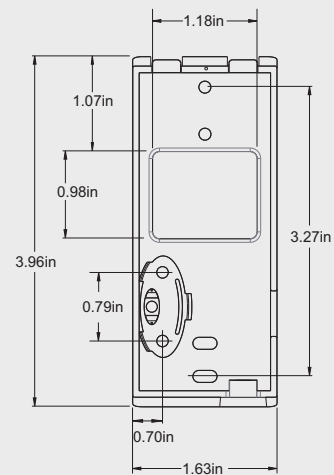

GS3-LF Mullion Proximity Reader	
Description	Mullion-style proximity reader
ID Technology	125 kHz - HID® Proximity and KeyPAC. 153 kHz - PAC and Readykey™. 13.56 MHz - Ops Lite (Mifare) and Ops (DESFire EV1)
Programmable Output	PAC (Readykey™), PAC64, Weigand and Magstripe
Dimensions	H: 4.1in x W: 1.8in x D: 1.1in
Weight	5.3 oz nominal
Maximum Read Range	Up to 4 in.
Environment	IP65 - Indoor / Outdoor weather resistant
Max. Current Requirements	< 100mA
Operating Voltage	12 VDC - 24 VDC Nominal (Range 10.5 to 28 VDC)
Recommended Cable Type	PAC Format: 22AWG 4-Conductor Unshielded, up to 800 ft Wiegand Format 22AWG 5-Conductor Shielded, up to 500 feet
Operating Temperature	-40° to + 151° F
Operating Humidity	10 to 85% relative humidity non-condensing (ULC S319 testing to 93%)
Audiovisual Indication	Bi-color LED (red-green) and audible sounder
Material	Polycarbonate UL94 HB (F1)
Tamper	Yes -wire tamper (PAC 512), case and wall
Certifications	UL 294 5th Ed. Attack Class 3, ULC S319-05 Class 3, UL 1610, ULC S304, UL 1076, ULC 1076, FCC Part 15 & IC RSS210
Ordering Information	75-20110 - Stanley GS3-LF Mullion Proximity Reader



CREDENTIAL READ RANGE

Stanley GS3 Mullion Reader	Up to 4 in.
-----------------------------------	-------------

CARD AND KEY FOB COMPATIBILITY

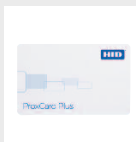
 K3010 / D8338	 K3011 / D8339	 K3011M	 HID 1346 ProxKey III
 K2010 / D8238	 STFOB	 K2011 / D8239 / STCARD	 HID1386 ISOProx II Card

